

**vtech**<sup>®</sup>  
Baby

Parent's Guide

# Shake & Sounds Caterpillar



91-003757-001 

VTech understands that a child's needs and abilities change as they grow and with that in mind we develop our toys to teach and entertain at just the right level...

## vtech *Baby*

Toys that will stimulate their interest in different textures, sounds and colours

### I am...

...responding to colours, sounds and textures

...understanding cause and effect

...learning to touch, reach, grasp, sit-up, crawl and toddle

Birth-36 months



## Pre-School

Interactive toys to develop their imagination and encourage language development

### I want...

...to get ready for school by starting to learn the alphabet and counting

...my learning to be as fun, easy and exciting as can be

...to show my creativity with drawing and music so my whole brain develops

3-6 years



## Electronic Learning Computers

Cool, aspirational and inspiring computers for curriculum related learning

### I need...

...challenging activities that can keep pace with my growing mind

...intelligent technology that adapts to my level of learning

...National Curriculum based content to support what I'm learning at school

4-10 years



To learn more about this and other VTech® products, visit [www.vtech.co.uk](http://www.vtech.co.uk)

# INTRODUCTION

Shake up playtime with this electronic rattle with a motion sensor. The cute caterpillar with a light up heart button plays sing-along songs, playful phrases and melodies. Little ones can fine-tune their motor skills by grasping the handle and ribbon legs. Multiple textures make it extra fun to explore the **Shake & Sounds Caterpillar!**

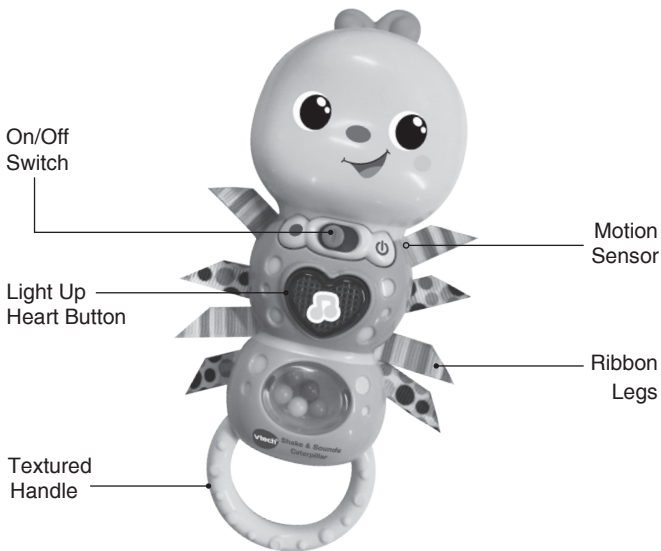

# INCLUDED IN THIS PACKAGE

- One **Shake & Sounds Caterpillar**
- One parent's guide

**WARNING:** All packing materials such as tape, plastic sheets, packaging locks, removable tags, cable ties and packaging screws are not part of this toy and should be discarded for your child's safety.

**NOTE:** Please keep this parent's guide as it contains important information.

**Unlock the packaging locks:**

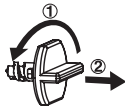

- ① Rotate the packaging lock 90 degrees anticlockwise.
- ② Pull out the packaging lock and discard.

# GETTING STARTED

## Battery Removal and Installation

1. Make sure the unit is turned **Off**.
2. Locate the battery cover and use a screwdriver to loosen the screws and open the battery cover.
3. Remove old batteries by pulling up on one side of each battery.
4. Install 3 new LR44 batteries following the diagram inside the battery box.  
(The use of new alkaline batteries is recommended for maximum performance).
5. Replace the battery cover and tighten the screws to secure.

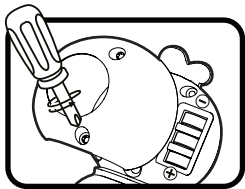

### **WARNING:**

This product contains a button or coin cell battery. A swallowed button or coin cell battery can cause internal chemical burns in as little as two hours and lead to death. Dispose of used batteries immediately. Keep new and used batteries away from children. If you think batteries might have been swallowed or placed inside any part of the body, seek immediate medical attention.

### **BATTERY NOTICE**

- Use three LR44 alkaline button cell batteries only for this toy.
- The button cell batteries used with this product should be kept away from small children who might still put things in their mouths. If the button cell batteries are swallowed, consult a doctor immediately.

- Insert the button cell batteries with the correct polarity.
- Do not use damaged button cell batteries.
- Do not short-circuit the button cell battery terminals.
- Remove exhausted button cell batteries from the product.
- Remove button cell batteries during long periods of non-use.
- Do not dispose of button cell batteries in fire.
- Do not charge non-rechargeable button cell batteries.
- Do not mix old and new batteries.
- Do not mix batteries of different types: alkaline, standard (carbonzinc) or rechargeable.

## **DO NOT USE RECHARGEABLE BATTERIES.**

### **Disposal of batteries and product**



The crossed-out wheeled bin symbols on products and batteries, or on their respective packaging, indicates they must not be disposed of in domestic waste as they contain substances that can be damaging to the environment and human health.



The chemical symbols Hg, Cd or Pb, where marked, indicate that the battery contains more than the specified value of mercury (Hg), cadmium (Cd) or lead (Pb) set out in Battery Directive (2006/66/EC).

The solid bar indicates that the product was placed on the market after 13th August, 2005.

Help protect the environment by disposing of your product or batteries responsibly.

For more information, please visit:

[www.recycle-more.co.uk](http://www.recycle-more.co.uk)

[www.recyclenow.com](http://www.recyclenow.com)

# PRODUCT FEATURES

## 1. On/Off Switch

To turn the unit **On**, slide the **On/Off Switch** to the **On** ☰ position. You will hear a playful caterpillar song, a phrase and sounds. To turn the unit **Off**, slide the **On/Off Switch** to the **Off** ● position.

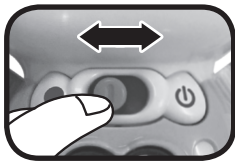

## 2. Automatic Shut Off

To preserve battery life, the **Shake & Sounds Caterpillar** will automatically power down after approximately 30 seconds without input. The unit can be turned on again by pressing the **Light Up Heart Button**. The **Motion Sensor** will not turn the unit back on.

### Note:

If the unit repeatedly powers down while playing, or the light up heart button fades out, we suggest changing the batteries.

# ACTIVITIES

## 1. Light Up Heart Button

Press the **Light Up Heart Button** to hear songs, phrases, sounds and melodies. The light will flash with the sounds.

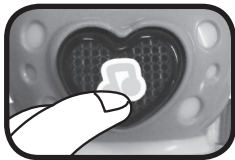

## 2. Motion Sensor

Shake the caterpillar rattle to trigger the **Motion Sensor**. You will hear sounds & phrases and see the light flash with the sounds.

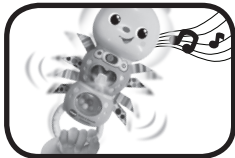

## 3. Tactile Stimulation

Encourage your baby's sense of touch with the **Textured Handle** and **Ribbon Legs**.

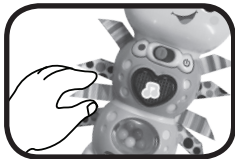

# MELODY LIST

1. Alphabet Song
2. Simple Simon
3. A-Ticket, A-Tasket
4. Farmer in the Dell
5. Hot Cross Buns
6. London Bridge
7. Sing a Song of Sixpence
8. Ring Around the Rosie
9. Looby Loo
10. Lavender's Blue



# SING-ALONG SONG LYRICS

## Song 1

I'm a friendly little caterpillar,  
I like to crawl.  
Give me a shake, give me a wiggle,  
And hear my happy little giggle.

## Song 2

You love me, and I love you,  
My big heart is full of love.

## Song 3

Lots of colours, bright and cheerful.  
I love colours, they brighten up my day.

## CARE & MAINTENANCE

1. Keep the unit clean by wiping it with a slightly damp cloth.
2. Keep the unit out of direct sunlight and away from any direct heat sources.
3. Remove the batteries if the unit will not be in use for an extended period of time.
4. Do not drop the unit on hard surfaces and do not expose the unit to moisture or water.

# TROUBLESHOOTING

If for some reason the unit stops working or malfunctions, please follow these steps:

1. Turn the unit **Off**.
2. Interrupt the power supply by removing the batteries.
3. Let the unit stand for a few minutes, then replace the batteries.
4. Turn the unit **On**. The unit should now be ready to use again.
5. If the unit still does not work, install a new set of batteries.

If the problem persists, please contact our Consumer Services Department and a service representative will be happy to help you.



# CONSUMER SERVICES

Creating and developing **VTech®** products is accompanied by a responsibility that we at **VTech®** take very seriously. We make every effort to ensure the accuracy of the information, which forms the value of our products. However, errors sometimes can occur. It is important for you to know that we stand behind our products and encourage you to call our Consumer Services Department with any problems and/or suggestions that you might have. A service representative will be happy to help you.

## **UK Customers:**

Phone: 0330 678 0149 (from UK) or +44 330 678 0149 (outside UK)  
Website: [www.vtech.co.uk/support](http://www.vtech.co.uk/support)

## **Australian Customers:**

Phone: 1800 862 155  
Website: [support.vtech.com.au](http://support.vtech.com.au)

## **NZ Customers:**

Phone: 0800 400 785  
Website: [support.vtech.com.au](http://support.vtech.com.au)

# PRODUCT WARRANTY/ CONSUMER GUARANTEES

## **UK Customers:**

Read our complete warranty policy online at [vtech.co.uk/warranty](http://vtech.co.uk/warranty).

## **Australian Customers:**

VTECH ELECTRONICS (AUSTRALIA) PTY LIMITED –  
CONSUMER GUARANTEES

Under the Australian Consumer Law, a number of consumer guarantees apply to goods and services supplied by VTech Electronics (Australia) Pty Limited. Please refer to [vtech.com.au/consumerguarantees](http://vtech.com.au/consumerguarantees) for further information.

**Visit our website for more  
information about our products,  
downloads, resources and more.**

***[www.vtech.co.uk](http://www.vtech.co.uk)***  
***[www.vtech.com.au](http://www.vtech.com.au)***

